

Features:

1. Two SIM Cards in one mobile phone, single standby
2. Auto-switch between SIM cards
3. Enable to edit switching time
4. Enable to edit and display name of SIM card which can be showed on phone's screen.

Installation:

1. Place the normal SIM into the SIM slot

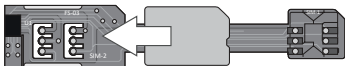

2. Place the Micro SIM on the adapter

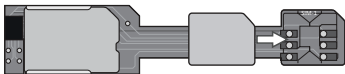

3. Turn OFF the mobile phone
4. Insert the adapter in the mobile's Micro SIM slot

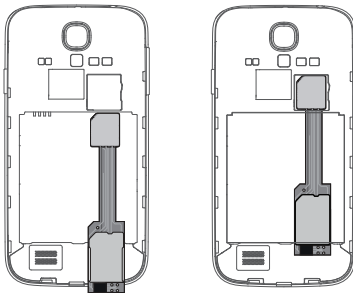

5. Power ON the mobile phone

Instruction:

1. Enter Setting – Phone - SIM Applications, it shows "SIMore" menu:

Switch Number

Switch Number:
Manual switching between SIM-1 to SIM-2
Select SIM-1 to activate SIM-1
Select SIM-2 to activate SIM-2

Short key function:
You can switch between SIMs by dialling the following short codes:
Dial #11 to select SIM-1
Dial #22 to select SIM-2
Dial #99 to pop up SIMore menu.

Set Number

Set Number:
Name SIM-1: Change name for SIM-1
Name SIM-2: Change name for SIM-2
Name SIM cards (SIM1 & SIM2) with number only.
(Default SIM cards name are SIM-1 & SIM-2).
Reset : press to reset SIM's name to default.

Auto/Switch

"Auto/SWITCH" Activation de la permutation automatique ON/OFF .
Switch automaticaly from SIM-1 to SIM-2.
The Auto Switching function is "OFF" by default.
ON: to switch ON the Auto/Switch function
OFF: to Switch OFF the Auto/Switch function
SIM1 Time:
Edit switching time by selecting SIM-1 time:03
SIM2 Time:
Edit switching time by selecting SIM-2 time:03
Default switch time: 3min.
Available switch time: 0 ~99min.
Ex: 75 = 1hour and 15 minutes.

Content:

·Dual SIM Adapter x 1

Notes:

Please restart the phone if no network's signal after switching.

Warning: the shortcut key function not supported by all mobile phones.

More information on :

WWW.SIMORE.COM