

Features:

1. Two SIM cards in one iPhone 5S, single standby
2. Auto-switch between SIM cards
3. Enable to edit switching time
4. Enable to edit display name of SIM which can be showed on iPhone screen.
5. Protective case with hang rope hole

Installation:

1. Place normal SIM into sim slot



2. Place nano adapter into metal card holder



3. Put nano SIM on the nano adapter

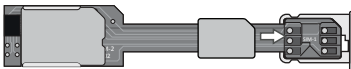

4. Fold the flexible PCB and insert into iPhone 5S



5. Insert into side slot of iPhone 5S

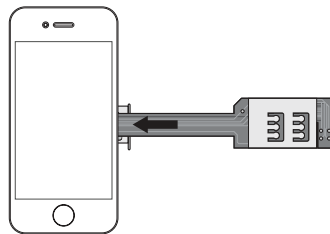

6. Put case on

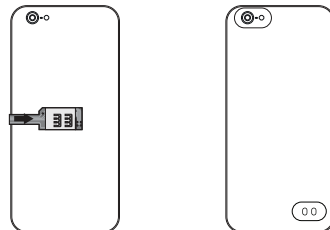

Chain manual:

1. Reeve the rope through the button

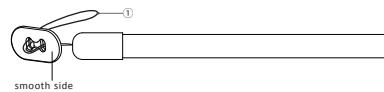

2. Reeve tail of rope through

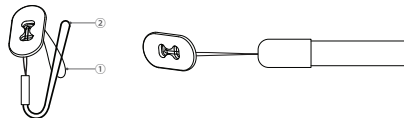

3. Put button into hole of the case and keep it flat at picture indicates

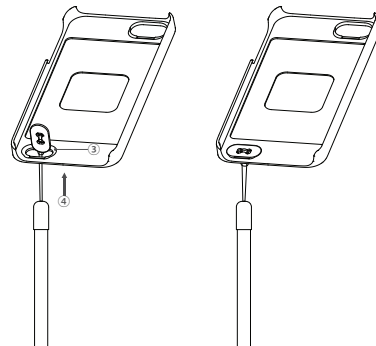

Instruction:

1. Enter Setting – Phone - SIM Applications, it shows “SIMore” menu:

Switch Number
Auto/SW
Setup

“Switch Number” offers SIM options: “SIM1” & “SIM2” which makes SIM work individually while “Auto/SW” makes both SIM work alternately.

2. “Setup” menu provides below options:

SIM1 NO.
SIM2 NO.
SIM1 Time:03
SIM2 Time:03

SIM1 NO. is to set numbers which SIM1 stands for.
SIM2 NO. is to set numbers which SIM2 stands for.
Default number is SIM1, another is SIM2.

Edit switching time by selecting “SIM1 TIME:03” and “SIM2 Time: 03”.
Default switch time: 3min.
Available switch time: 0 ~99min.

Content:

- Nano SIM holder×1
- Dual SIM Adapter×1
- Button of chain×1
- Protective case×1
- Manual×1

Notice!

Please restart iPhone 5S if no network's signal after switching.

More information on :

WWW.SIMORE.COM