

SIMORE

GoldBox

QUICK START

1. Download SIMore App available on App Store

2. Turn ON iPhone's Bluetooth

3. Insert Micro SIM Card into the GoldBox device

Note: PIN code of the SIM card has to be disable
(No PIN code on the SIM card)

Warning: If you use a Nano/Micro SIM adapter

Never insert an empty adapter in the device

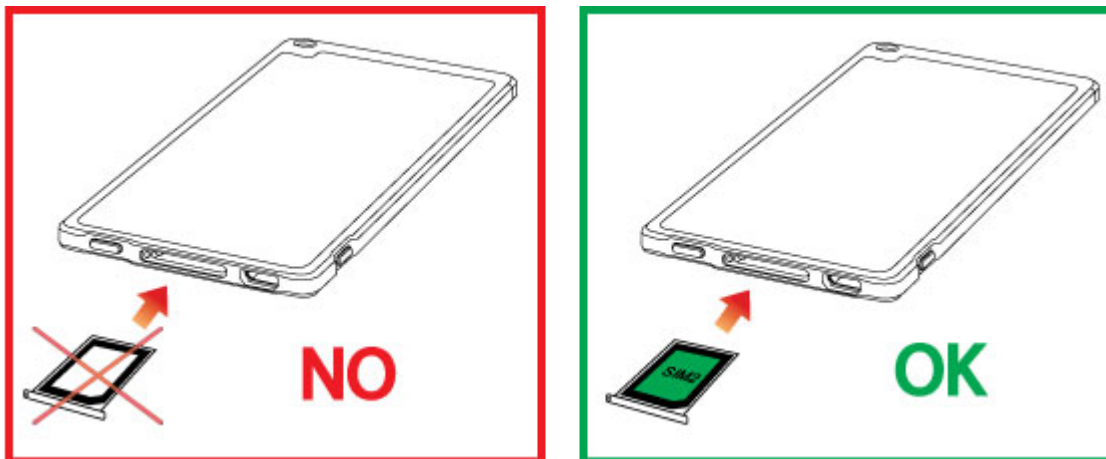

4. To connect GoldBox, open SIMore App and go to:

Setting → Search devices → Click on SIMore name ID to connect it

5. Enter the Bluetooth code: 0000