

Features:

1. Two SIM cards in one iPhone, single standby
2. Auto-switch between SIM cards
3. Enable to edit switching time
4. Enable to edit display name of SIM which can be showed on iPhone screen.

Installation:

1. Place normal SIM into sim slot

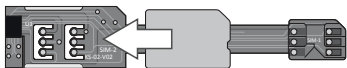

2. Place Micro adapter into metal card holder



3. Put Micro SIM on the Micro adapter

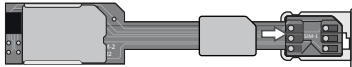

4. Fold the flexible PCB and insert into iPhone



5. Insert into side slot of iPhone

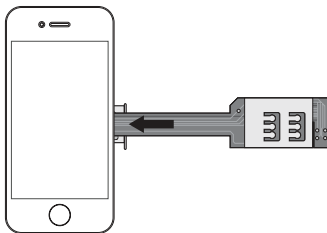

6. Put case on

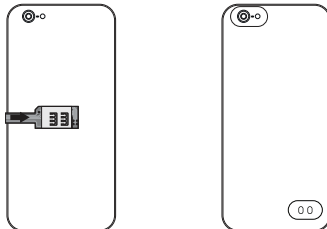

Instruction:

1. Enter Setting – Phone - SIM Applications, it shows "SIMore" menu:

Switch Number
Auto/SW
Setup

"Switch Number" offers SIM options: "SIM1" & "SIM2" which makes SIM work individually while "Auto/SW" makes both SIM work alternately.

2. "Setup" menu provides below options:

SIM1 NO.
SIM2 NO.
SIM1 Time:03
SIM2 Time:03

SIM1 NO. is to set numbers which SIM1 stands for.
SIM2 NO. is to set numbers which SIM2 stands for.
Default number is SIM1, another is SIM2.

Edit switching time by selecting "SIM1 TIME:03" and "SIM2 Time: 03."
Default switch time: 3min.
Available switch time: 0 ~99min.

Content:

- Dual SIM Adapterx1
- Protective casex1
- Manualx1

Notice!

Please restart iPhone if no network's signal after switching.

More information on :

WWW.SIMORE.COM